

Everyvalve Ltd Web Catalogue Page 28 : Hose Fittings

HOSE BARB FITTING (Black PP)				
<a href="#">Hose Tee / L / Mender / Y Data sheet</a>				
Item	T	Ref	£ (A)	£ (B)
1	6mm	28PHTA01	£1.65	-
1a	6mm	T15644646	<a href="#">Tefen Page</a>	
2	10mm	T45641212	<a href="#">Tefen Page</a>	
3	13mm	28PHTB03	-	£0.44
4	16mm	28PHTB04	-	£0.68
5	20mm	x 1/2" BSP	28PHTB05	£0.81
6	20mm	28PHTB06	-	£0.66
7	25mm	28PHTB07	-	£0.81
8	25mm	x 20mm Branch	28PHTB08	£1.12
9	32mm	28PHTB09	-	£1.06
10	40mm	28PHTB10	-	£1.65
11	50mm	28PHTB11A	-	£6.08



Hose Tee

Hose Y (Black PP)				
Item	Y	Ref	£ (A)	£ (B)
1	6mm	28PHYA01	£2.58	-
1a	6mm	T12446346	<a href="#">Tefen Page</a>	
2	10mm	28PHY02	-	£2.42
3	13mm	28PHY03	-	£1.74
4	16mm	28PHYA04	NATURAL	£2.33
5	20mm	28PHY05	-	£2.09
6	25mm	28PHY06	-	£5.62



Hose Y

Hose Elbow (Black PP)				
Item	L	Ref	£ (A)	£ (B)
1	6mm	28PHLA01	£0.76	-
1b	6mm	T15654600	<a href="#">Tefen Page</a>	
2	10mm	28PHLA02	£1.09	-
2b	10mm	T45651200	<a href="#">Tefen Page</a>	
3	13mm	28PHLB03	-	£0.38
4	16mm	T45652000	<a href="#">Tefen Page</a>	
5	20mm	28PHLB05	-	£0.62
6	25mm	28PHLB06	-	£0.71
7	32mm	28PHLB07	-	£0.97
8	40mm	28PHLB08	-	£1.29
9	50mm	28PHLB09A	-	£3.89



Hose L

Hose Cross (Clear PP)				
Item	H.C.	Ref	£ (A)	£ (B)
1	6mm	28PHCA01	-	-
2	10mm	28PHCA02	-	£2.86
3	13mm	28PHCA03	-	£3.15
4	16mm	28PHCA04	-	-



Hose Cross

Hose Mender (Black PP)				
Item	H.M.	Ref	£ (A)	£ (B)
1	6mm	28PHM01A	£0.82	-
2	10mm	T45621200	<a href="#">Tefen Page</a>	
3	13mm	28PHM03	-	£0.38
4	16mm	28PHM04B	-	£0.41
5	20mm	28PHM05	-	£0.45
6	25mm	28PHM06	-	£0.62
7	32mm	28PHM07	-	£0.81
8	40mm	28PHM08	-	£1.32
9	50mm	28PHM09A	-	£3.59

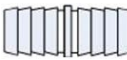

Hose Mender

Hose Menders Reducing (Black PP) No Natural (A)				
Item	H. M. R.	Ref	£ (A)	£ (B)
1	10mm x06mm	T15565046 - n	-	<a href="#">Tefen</a>
2	13mm x10mm	T45561216	-	<a href="#">Tefen</a>
3	16mm x13mm	TBA	-	<a href="#">Tefen</a>
4	20mm x16mm	T45561620	-	<a href="#">Tefen</a>
4b	20mm x13mm	28PHMR04B	-	£0.62
4c	26mm x13mm	28PHMR04C	-	£0.71
5	25mm X20mm	28PHMR05	-	£0.49
6	32mm x26mm	28PHMR06	-	£0.84
7	32mm x20mm	28PHMR07A	-	£0.81
8	38mm x32mm	28PHMR08	-	£2.16
9	38mm x25mm	28PHMR09	-	£1.74
10	50mm x38.50mm	28PHMR10	-	£3.25



Reducing Hose

PP Hose Adapters (M / Thread x Hose) (Black PP)				
Item	BSPm	Tail	Ref	£
1	1/4"	6mm	28PHA01	£0.69
2	1/4"	10mm	T45681204	<a href="#">Tefen</a>
3	1/4"	12mm	28PHA03	£1.11
4	3/8"	10mm	28PHA04	£0.70
5	3/8"	12mm	28PHA05	£0.92
6	3/8"	16mm	28PHA06	£1.11
7	1/2"	10mm	T45681208	<a href="#">Tefen</a>
8	1/2"	13mm	28PHA08	£0.82
9	1/2"	16mm	28PHA09	£0.91
10	1/2"	20mm	28PHA10	£0.96
11	3/4"	10mm	28PHA11	£1.02
12	3/4"	13mm	28PHA12	£0.84
13	3/4"	16mm	28PHA13	£0.92
14	3/4"	20mm	28PHA14	£0.97
15	3/4"	25mm	28PHA15	£1.11
16	1"	20mm	28PHA16	£1.13
17	1"	25mm	28PHA17	£1.23
18	1"	32mm	28PHA18	£1.39
18a	1 1/4" NPT	20mm	28PHA18A	£2.75
19	1 1/4"	25mm	28PHA19	£1.62
20	1 1/4"	32mm	28PHA20	£1.95
21	1 1/4"	40mm	28PHA21	£2.38
22	1 1/2"	38mm	28PHA22	£2.38
22a	1 1/2"	40mm	28PHA22A	£2.54
23	1 1/2"	50mm	28PHA23	£3.07
24	2"	50mm	28PHA24	£3.38
25	3"	75mm	28PHA25	£6.71
25a	3"	75mm	28PHA25A	£10.53
25b	4"	100mm	28PHA25B	£7.58

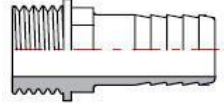

Lugged Type

STD Flange - Heavy GR-PP In Black - Hex

Lugged Type

Stepped Hose Adaptors Male (Multi Hose Fit) (Black PP)				
Item	BSPm	Tail	Ref	£
25b1	1/2"m	10/13/20	28PHA25B1	£0.87
25c	3/4"m	13/20/25	28PHA25C	£0.92
25d	1"m	20/25/32	28PHA25D	£1.06
25e	1 1/4"m	25/32/38	28PHA25E	£1.22
25f	1.1/2"m	13/20/25/32/38	28PHA25F	£1.74

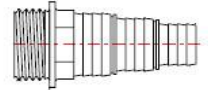

Stepped Hose Adaptors Female (Multi Hose Fit) (Black PP)				
Item	BSPf	Tail	Ref	£
25g	1" f	13/20/25	28PHA25G	£1.32
25h	1.1/4" f	20/25/32	28PHA25H	£1.65

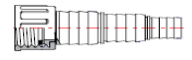

In Black PP. For OEM clients. Cutting Slots for length determination

Hose Adaptors Bent 90° Version (Black PP)				
Item	BSP	Tail	Ref	£
26	3/8"	12mm	28PHA26	£1.69
27	1/2"	13mm	28PHA27	£1.36
28	1/2"	16mm	28PHA28	£1.51
29	1/2"	20mm	28PHA29	£1.65
30	3/4"	12mm	28PHA30	£1.39
31	3/4"	20mm	28PHA31	£1.63
32	3/4"	25mm	28PHA32A	£1.95
32b	1" NPT	20mm	28PHA32B	£3.32
33	1"	25mm	28PHA33	£1.98
34	1"	32mm	28PHA34	£2.54
35	1 1/4"	32mm	28PHA35	£2.63
36	1 1/2"	40mm	28PHA36	£3.11
37	2"	50mm	28PHA37	£4.30

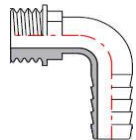

Hose Adaptors Female Nut Liner & Seal Versions (in Line) (Black PP)				
Item	BSPf	Tail	Ref	£
38	3/8"	10mm	28PHA38	£1.26
39	1/2"	13mm	28PHA39	£1.48
40	3/4"	10mm	T15475012	<a href="#">Tefen</a>
40a	3/4"	13mm	28PHA40A	£2.00
40b	3/4"	16mm	28PHA40B	£2.00
40c	3/4"	20mm	28PHA40C	£1.67
41a	1"	20mm	28PHA41A	£1.81
41b	1"	25mm	28PHA41B	£1.87
42	1 1/4"	20mm	28PHA42	£2.38
42a	1 1/4"	25mm	28PHA42A	£3.00
42b	1 1/4"	32mm	28PHA42B	£2.62
43	1 1/2"	40mm	28PHA43	£3.35
43a	1 1/2"	38mm	28PHA43A	£3.33
44	2"	50mm	28PHA44	£4.34
44b	3"	76mm	28PHA44B	£11.76
44c	4"	100mm	28PHA44C	£15.58

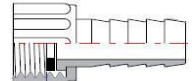

Lugged Type

Lugged Type

PLEASE NOTE : Prices subject to change without prior notice.

Updated 1/02/2024

1707 642018 | FAX : 0044 (0)1707 646340 | www.everyvalve.com | sales@everyvalve.com

MANUFACTURER AND SUPPLIERS TO COMMERCIAL INDUSTRIES.

Everyvalve Ltd Web Catalogue Page 28 : Hose Fittings

Hexagon Keys - Hose Adapters PP		
(see codes for fitting sizes) Free with 100HA		
HKS 20mm/24mm/30mm sizes	28PHA56	£0.87
HK 33mm / 41mm Sizes	28PHA57	£0.87

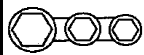

Hose Barb Fittings - Notes
'A' Column is Laboratory Standard Nat PP
'B' Column is Economy Black/Nat PP
Technical
Hose Tail sizes given fit bore of Hose with same size (interference fit)
Max Pressure = 8 Bar at ambient temperature
Max temperature 80° deg C at reduced pressure

Fittings
(np=NPT, n=Nylon, p=PVC)

Packs sizes
UPTO 1.1/4" - Qty 100 / UPTO 2" - Qty 50 / UPTO 4" - Qty 5

Hose Adaptor Notes
12mm & 25mm sizes are metric sizes
'A' Column is Std Black From Mar 2011 PP + Flange
'B' Column is Economy Black PP - Flange
Different Specs for other materials

<a href="#">Tefen Products - see Tefen Page</a>
Ask for CAD Drawing for full dimensions
Minimum Order Value £ 30.00   Minimum Line Value Per Order £ 6.00
Many of these are UK Made

Hose Adapters Female Nut Liner & Seal Versions (90°) (Black PP)				
Item	BSPf	Tail	Ref	£
45a	½"	12mm	28PHA45A	£2.14
45b	¾"	12mm	28PHA45B	£2.40
45c	3/4"	16mm	28PHA45C	£2.40
46	3/4"	20mm	28PHA46	£2.40
47a	1"	25mm	28PHA47A	£2.86
47bc	1½"	25mm	28PHA47BC	£4.22
47b	1½"	32mm	28PHA47B	£3.68
47c	1½"	40mm	28PHA47C	£5.23
47d	2"	50mm	28PHA47D	£6.89

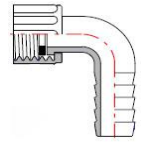

Hose Adapters Female Single Piece Hose Adapter (Black PP)				
Item	BSPf	Tail	Ref	£
48	¾"	10mm	28PHA48	<del>DISCONTINUED LINE</del>
49	¾"	10mm	28PHA49	£0.87
50	¾"	16mm	28PHA50	£0.87
51	¾"	20mm	28PHA51	£0.87

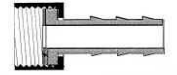

Hose Adapter BSP x Twin Barb HoseTails (Black Acetal)				
Item	BSP	Tail	Ref	£
52	¾"	10mm	28PHA52	£0.92
53	¾"	13mm	28PHA53	£1.06
53b	¾"	20mm	28PHA53B	£1.19
53ba	¾"	25mm	28PHA53BA	£1.67
53c	1"	25mm	28PHA53C	£2.27
53d	1"	32mm	28PHA53D	£2.61
53e	1.1/4"	32mm	28PHA53E	£2.74



Hose Adapter BSP x Tri Barb Hose Tails (Black Acetal)				
Item	BSP	Tail	Ref	£
54	¾"	10mm	28PHA54	<del>DISCONTINUED LINE</del>
55	¾"	13mm	28PHA55	£1.39



**Notes:**

---

---

---

---

---

---

---

---

---

---

---

---

---

---

---

---

---

---

---

---

---

---

---

---

---

---