

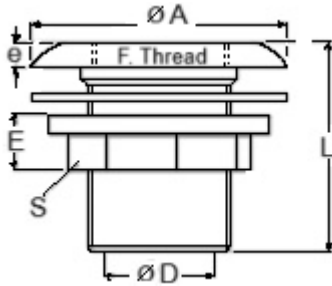

Bulk Head Fittings in PPG

780

PPG



Bulkhead Fittings Threaded with BSP Male BSP size. One size less in front mushroom head

Matière : PPG
Sealing : **Gasket Std EPDM ou FKM(Special)**
Dimensions : **DN15 à DN80**
Tightening : **Hex Nut with Round Face**
Température de service : **-10°C à + 110°C**
Raccordement : **Threaded with Gas / BSP thread cylindrical to norme ISO 228/1**



DN mm	Ød mm	G pouces	ØA mm	ØD mm	e Mm	E mm	L mm	S mm	Thickness wall maxi mm	Ø drilling mm	Weight grs	Réf. de cde PPG/EPDM	Réf. de cde PPG/FKM
15	20	1/2"	46	12	7	17	62	30	30	21	30	7225.786	7255.786
20	25	3/4"	52	16	7	17	68	34	35	26.5	38	7225.787	7255.787
25	32	1"	65	22	8	18	76	45	35	33	70	7225.788	7255.788
32	40	1 1/4"	78	30	9	20	76	55	30	42	100	7225.789	7255.789
40	50	1 1/2"	90	35	10	23	76	61	25	47.5	140	7225.790	7255.790
50	63	2"	106	45	10	23	76	72	23	59.5	200	7225.791	7255.791
80	90	3"	136	70	11	27	78.5	104	10	88	470	7225.793	7255.793

Bulk Head Fittings Male Female BSP in PPG

740

PPG

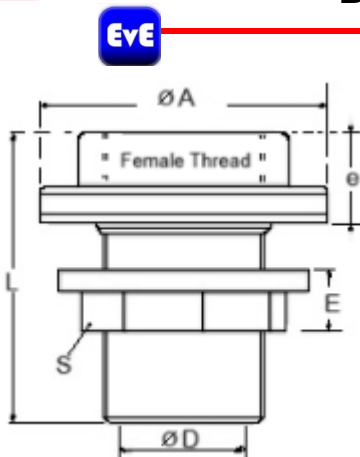

Main Fittings BSP threaded Male & female (Same Size) on front face.

Material : PPG
Dimensions : **DN15 à DN80**
Fixation : **Hex Nut with round face**
Température of service : **-10°C à + 110°C**
Connection : **ThreadedeBSP/Gas cyindrical to norme ISO 228/1**



mm	mm	pouces	mm	ØD mm	e Mm	E mm	L mm	S mm	Thickness Wall maxi mm	Ø perçage mm	Weight grs	Réf. de cde PPG/EPDM	Réf. de cde PPG/FKM
15	20	1/2"	46	12	20	17	82	30	30	21	40	7225.746	7255.746
20	25	3/4"	51	16	20	17	88	34	35	26.5	48	7225.747	7255.747
25	32	1"	64	22	26	18	98	45	35	33	80	7225.748	7255.748
32	40	1 1/4"	76	30	25	20	100	55	30	42	110	7225.749	7255.749
40	50	1 1/2"	90	35	25	23	100	61	25	47.5	150	7225.750	7255.750
50	63	2"	98	45	31	23	113	72	23	59.5	220	7225.751	7255.751
80	90	3"	136	70	35	27	120	104	10	88	500	7225.753	7255.753

Manufacturer reserves the right to change the contents without notice